

WE WANT TO SEE YOUR ALCLAIRS!

Post a picture, review or unboxing so we can see it and share it! Tag or mention @ALCLAIROUTDOORS on Instagram and Facebook.

GETTING STARTED



1. Your earplugs are custom made for your ears. In order to get the most out of them, it is important to insert them into your ears properly. It is best to start with our tutorial video at <https://alclr.co/insertvideo> or you can scan the QR code.

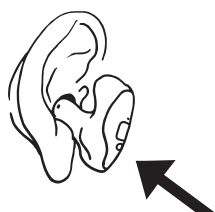

Place the hearing protection into your ear with the top facing towards the front.

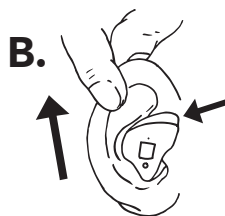

Pull out on the top of your ear and rotate the earplug backwards.

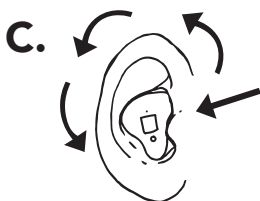

Continue to rotate the earplug back, "screwing" it into your ear until it seats.

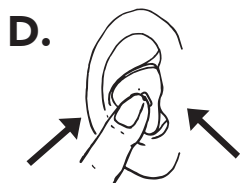

Press firmly on the earplug to ensure a good seal.

- Your earplugs should not be painful to wear, but might cause slight discomfort for a period of time as your ears get used to wearing them.
- In order to properly protect your hearing, you should have a good seal on your hearing protection. While it is nearly impossible to have a perfect seal 100% of the time, they should seal the majority of the time you are using them.

There are a couple of ways to tell which earplug is left and which is right.

ALCLAIR EXP and ACRYLIC HEARING PROTECTION
The back of the hearing protection will have a colored name with red for right and blue for left.

SILICONE EARPLUGS: Look on the bottom of the earplug, the red dot indicates the right earplug.

BATTERY CARE

Make sure to open the battery door when you store your EXP earplugs. This will prolong the battery life.

To replace the batteries on your Alclair EXP, open the door on the face plate by gently pulling on the rounded tab. The door will swing open to expose the batteries for replacement. The battery is an A13 style battery and can be ordered from Alclair, purchased at a hearing aid center, or most drugstores.

NOTE: Higher volumes will decrease battery life.

VOLUME AND PROGRAM SELECTION

Use the volume knob to adjust the volume of the incoming audio. Turning the knob towards your face will increase the volume (clockwise on the right ear and counter-clockwise on the left ear).

Press the small button above the battery door to select one of the four programs. Each mode (explained below) will have an audible beep to indicate the selected program.

EXP PRO PROGRAM MODES

The Alclair EXP Pro features four programs, each with a different audio profile. Use the Select button to cycle through the options to find the right program for your current needs.

MODE 1: ACCURATE

This mode offers a balanced sound with minimal enhancement, giving you an accurate representation of the sounds around you.

MODE 2: FIELD FOCUS

This mode offers greater sensitivity to the sound of game, human conversation, and more. Everything is a bit clearer and crisper, especially in the upper range.

MODE 3: CLARITY FOCUS

This program removes some of the low end that can cause muddiness so you can focus on important sounds. This is a great profile for those who have been affected by moderate hearing loss.

MODE 4: NATURAL

This mode augments your hearing in a way that feels natural. It minimizes distracting noise and accentuates the sounds that matter, so you can pinpoint their source and gain a real advantage without it ever feeling artificial.

CARING FOR YOUR HEARING PROTECTION

PROTECT & CLEAN

When done using your hearing protection, clean them and store them in their case. Do not use a toothpick or other sharp object to clean your earplugs or hearing protection. Doing so may cause damage.

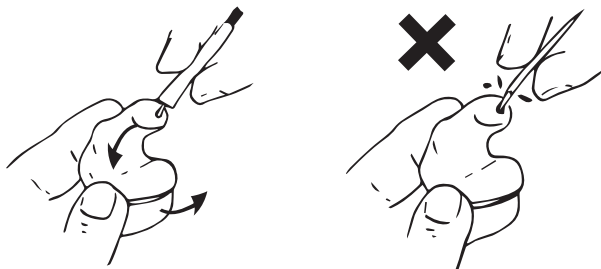

WAX

The vast majority of repairs that we see are due to wax buildup in the tubes. If your Alclair EXP sound uneven or start to lose some frequencies, please contact us so that we can get them repaired.

DROPS

The Alclair EXP uses high quality components but they are still susceptible to physical damage from collision. Please protect your Alclair EXP from falls and impact.

STORAGE

Keep your hearing protection in the case when you are not using them. When placing your hearing protection or earplugs in a hard shell case, make sure they are not overlapping or stacked before closing the lid.

SURE-FIT GUARANTEE

Your earplugs are based on the impressions you sent us. Most of the time, they will fit great but there is a chance that adjustments will need to be made for a proper fit. Please let us know as soon as possible if you have fit issues so that we can make adjustments.

TROUBLESHOOTING AND MAINTENANCE

I am getting feedback.

Feedback usually occurs if you don't have a good seal or are using them too loud. Make sure your Alclair EXP is fully in your ear and you have a good seal. If you continue to experience feedback, contact us and we will work with you on the fit/seal..

REPAIR

If you are experiencing problems with your hearing protection, please contact us. Repairs take roughly 7-20 business days to complete depending on the repair. All repairs require an RMA number. Please contact us to set up the repair.

ALCLAIR AUDIO
8700 Jefferson Hwy
Osseo, MN 55369

(800) 933-9899
(763) 315-3007

sales@alclair.com
alclair.com/support